

DXRACER

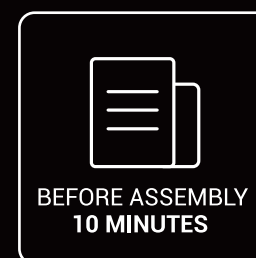

NUMBER OF PEOPLE
2



BEFORE ASSEMBLY
10 MINUTES



ASSEMBLY TIME
25 MINUTES

Please follow the assembly instructions on the back of this sheet.



Scan the QR code to access
the assembly video.

Quick Installation

step
1.

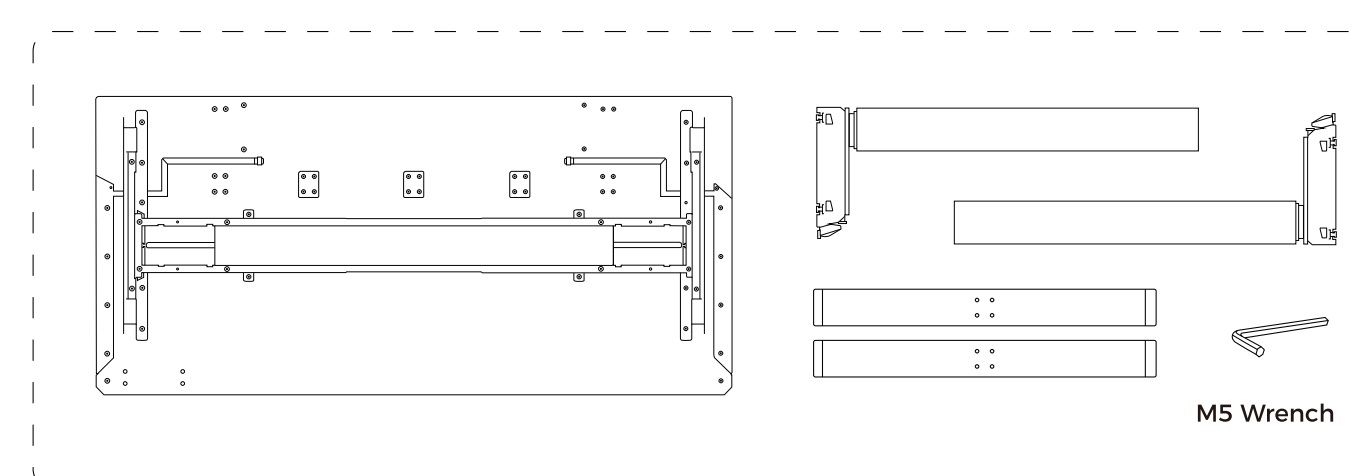

1.1

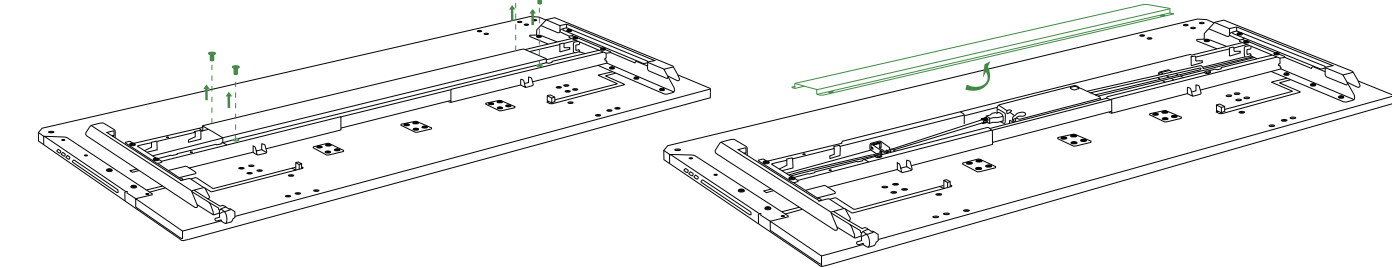

1.2

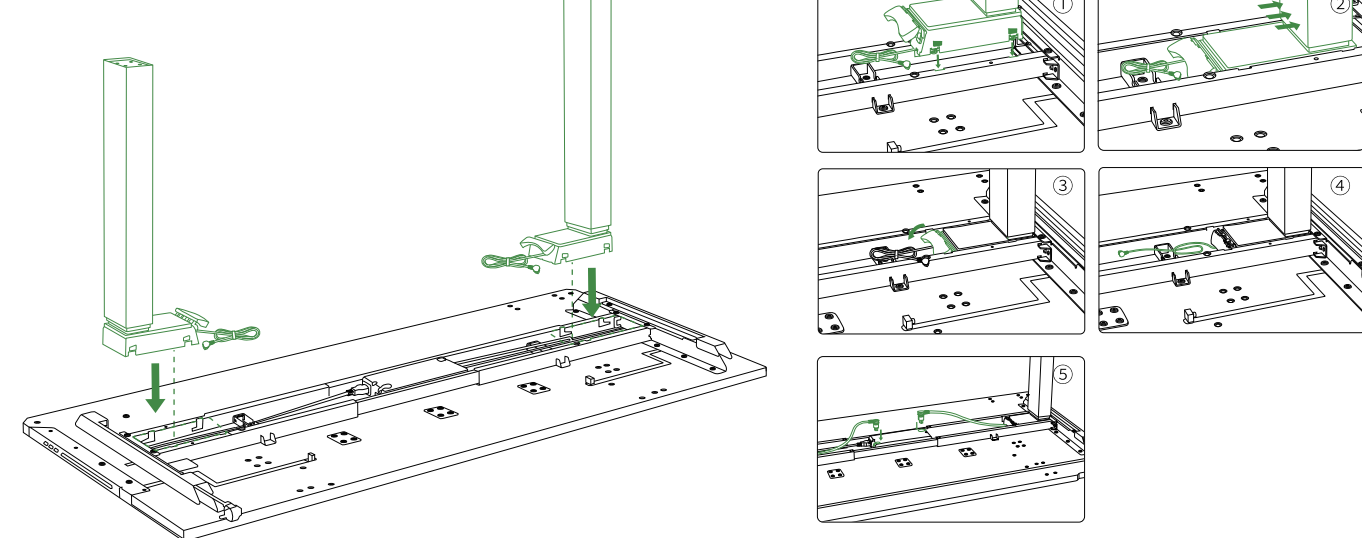

1.3

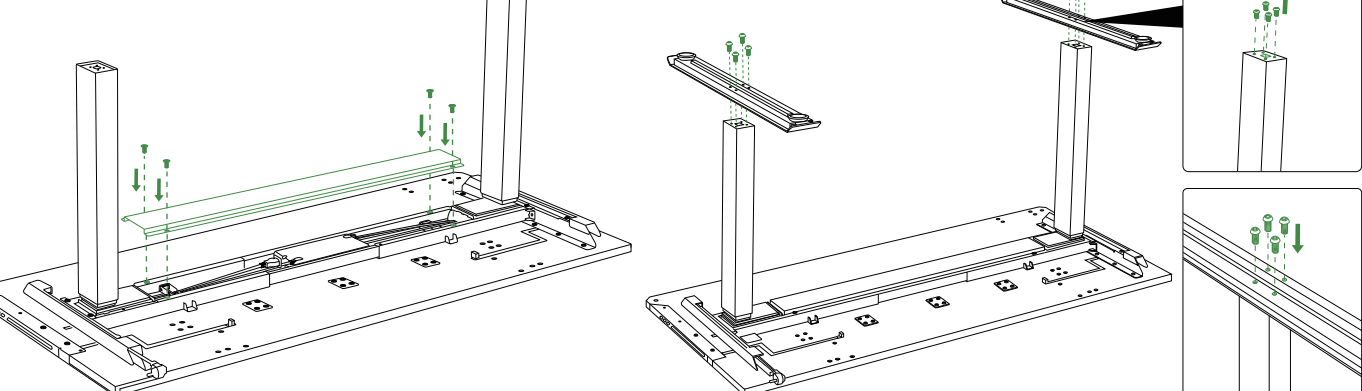

step
2.

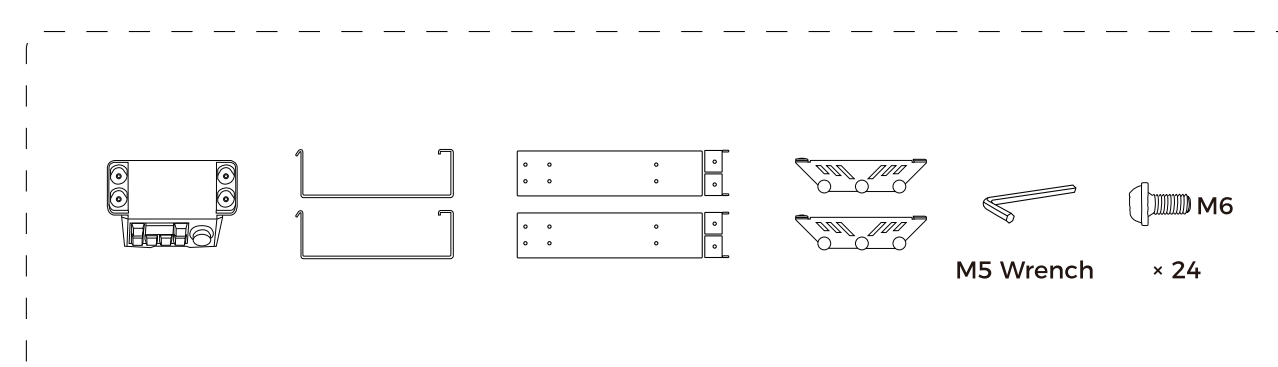

2.1

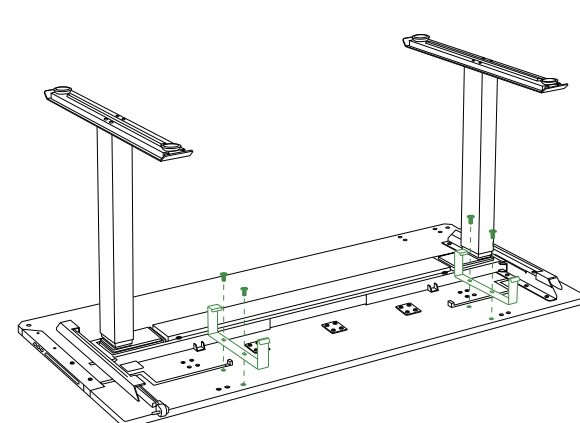

2.2

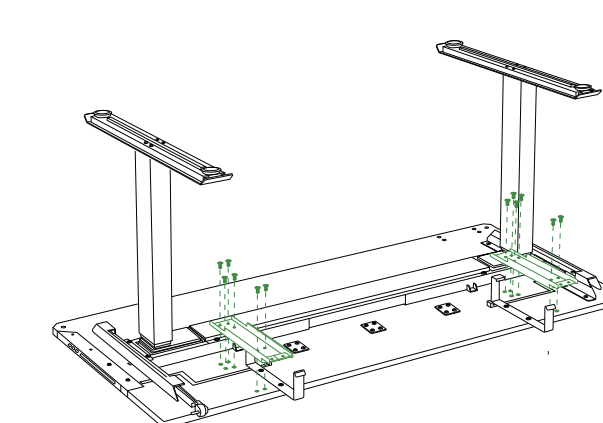

2.3

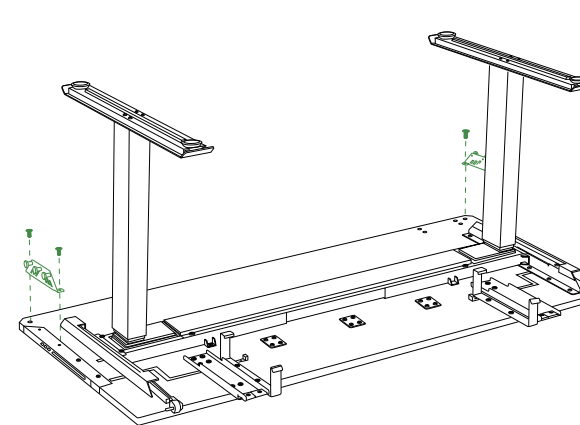

2.4

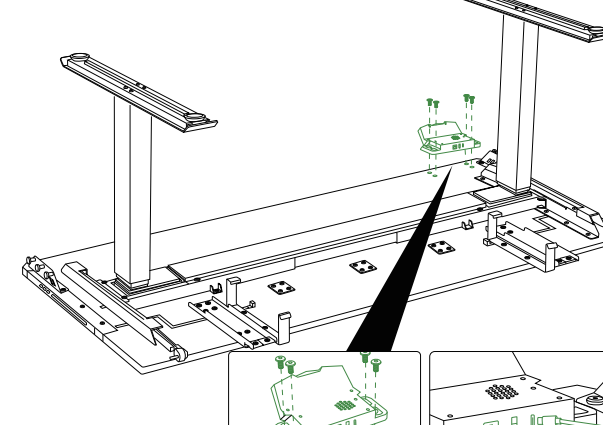

step
3.

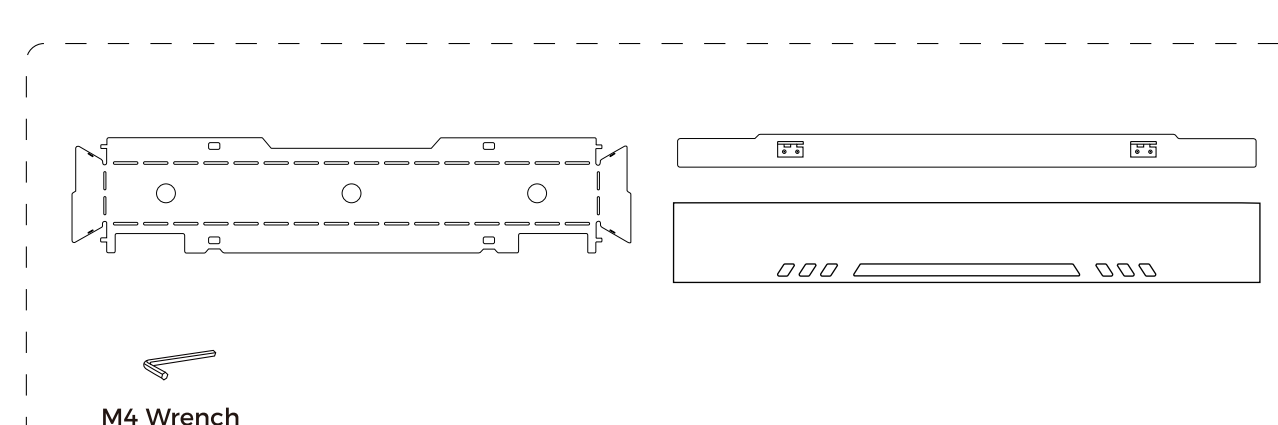

3.1

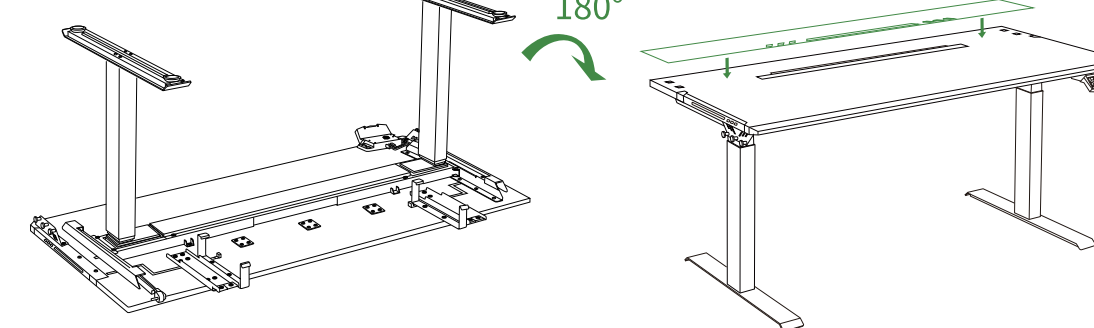

3.2

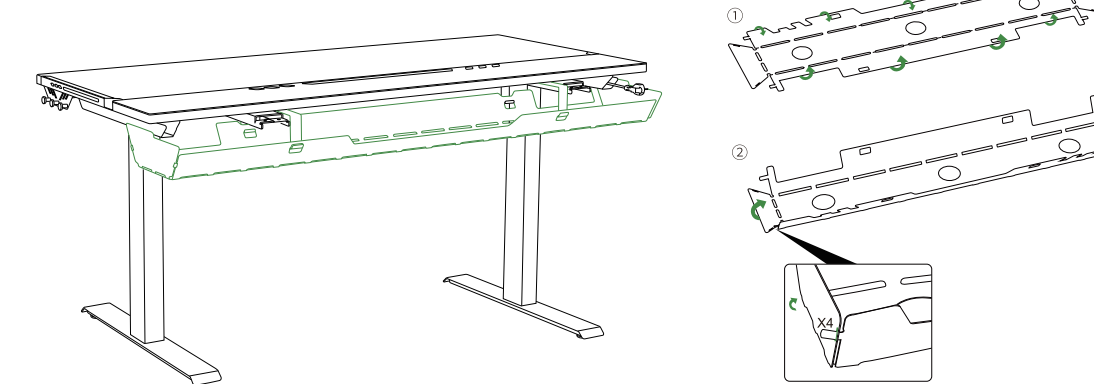

3.3

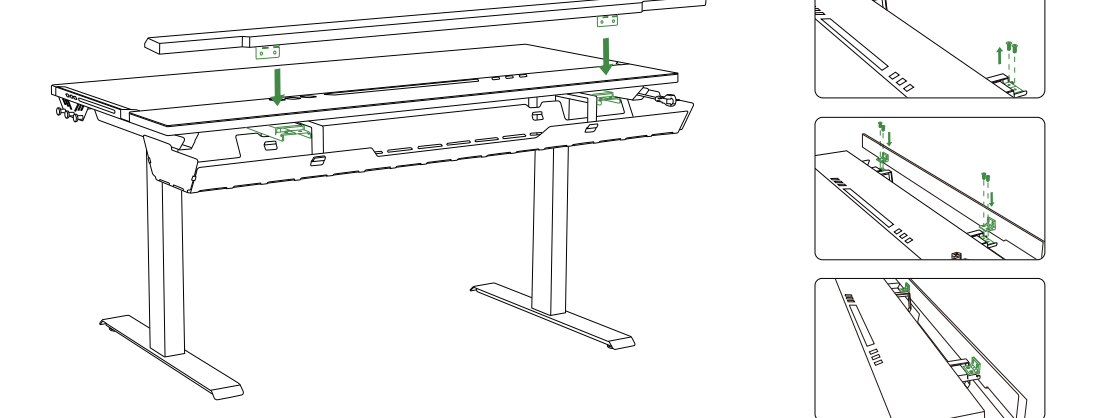

step
4.

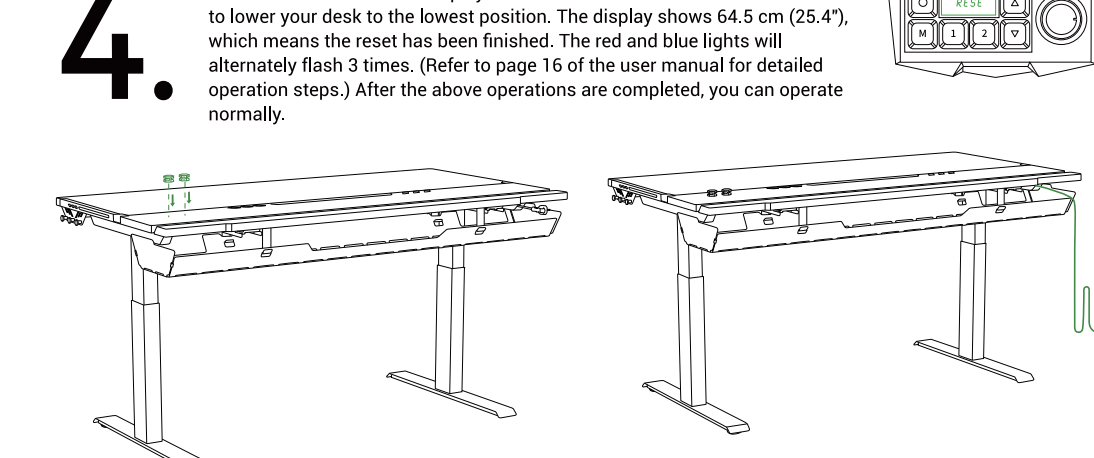

step
5.

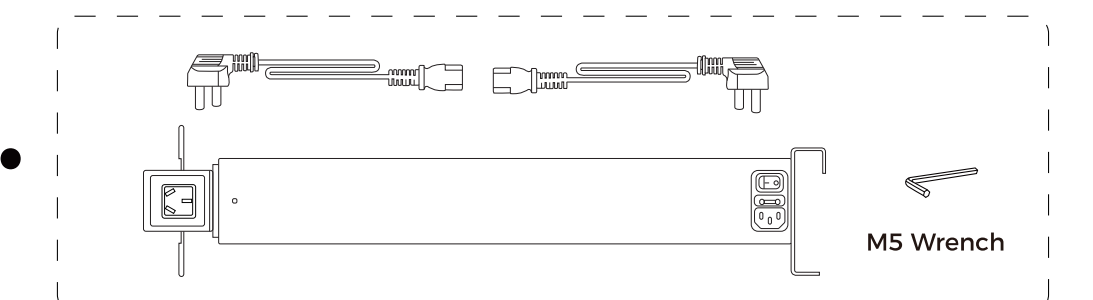

5.1

Press and hold the "▲" button to raise the desk to a suitable position for installing the integrated power supply column (a height exceeding 110.0 cm is recommended).

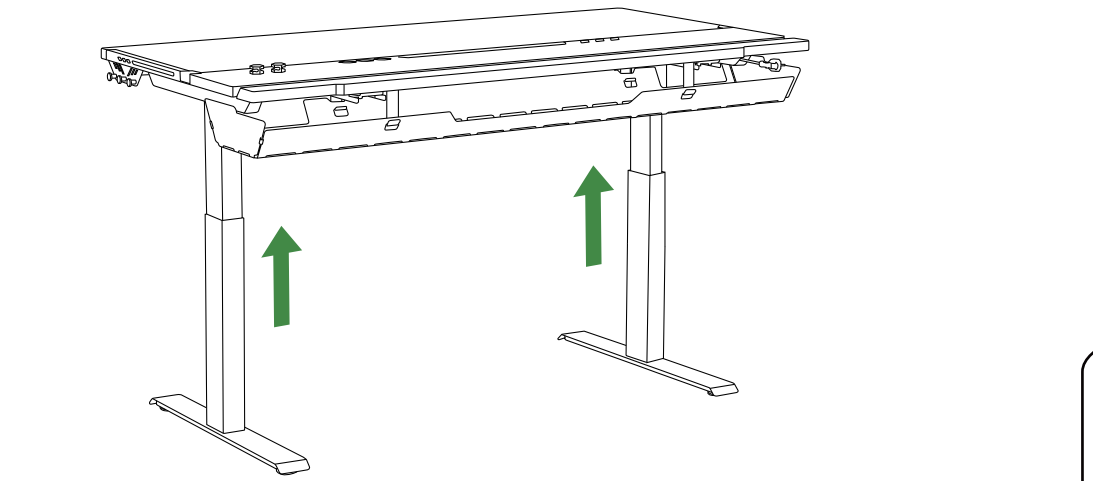

5.2

Installation of the integrated power supply column

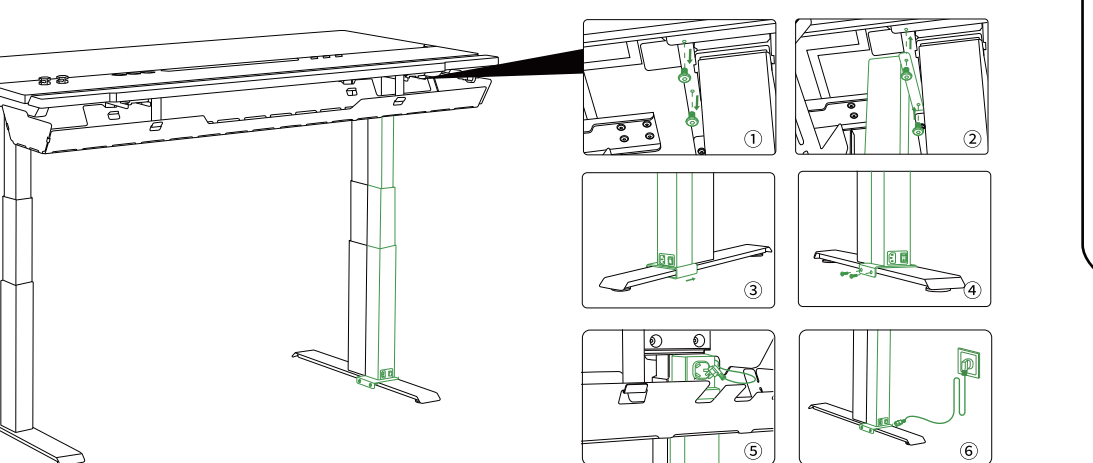

5.3

Installation of integrated weak power supply column (A separate purchase is required)

